

The image features a decorative background. On the right side, there is a large, dark green monstera leaf with characteristic splits. A large, semi-transparent white rectangle covers the central portion of the image, serving as a backdrop for the text. The background also includes soft, light-colored geometric shapes in shades of blue and pink.

Sunrise Meadow trail concern

June 19, 2024 reported dumping on the trail

June 28, tires and plastic had been removed, but Brush and lumber remained.

Oct 10, reported that the natural water flow had been dammed



19) Canyon Cove

20) China Flat

21) Medea Creek Natural Park (Trail)

22) Oak Canyon Community Park (Trail)

23) Rock Ridge

24) Rock Ridge (East)

25) Sunrise Meadow Creekside

26) Sunrise Meadow Ridge

27) Wistful Vista

E) Indian Springs Park (access to #27)

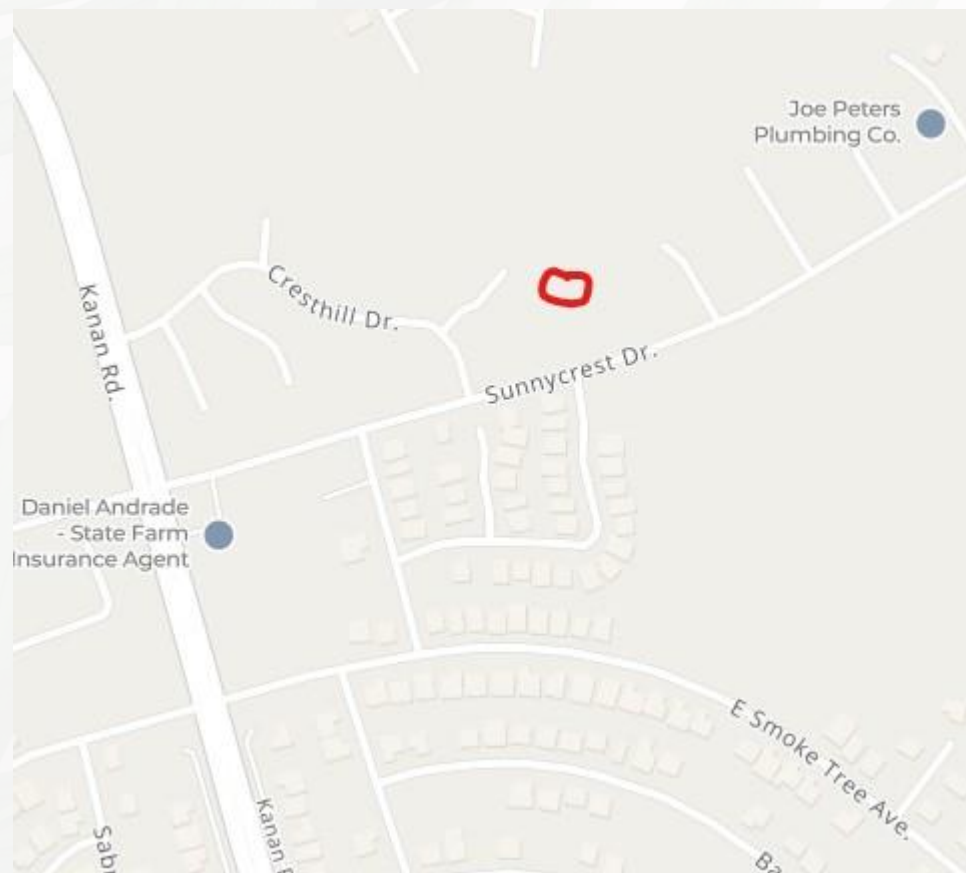

Dec 31, 2024



Feb 26, 2025

Water is continually blocked

What can we do to get
this watercourse
repaired?





Thank you

Brett Austin

805-910-8859

Brettaustin2240@gmail.com